

DIN SWING CHECK VALVE PN16

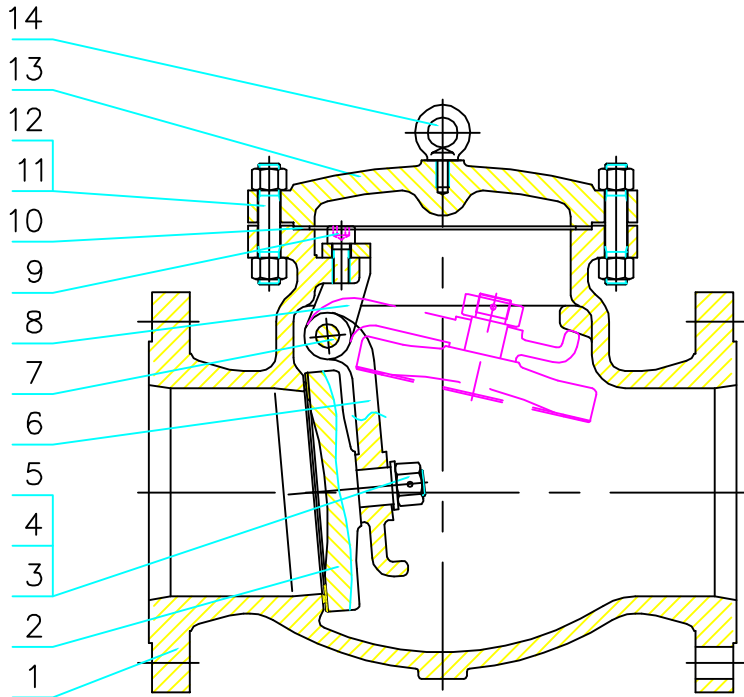

Standard and Specification/标准与规范			
Designs standard 设计标准	Face to Face 结构长度	Flange connection 法兰连接	Testing standard 试验与检验
DIN 3356	DIN 3202	DIN2543-2547	DIN 3230

Performance Specification/性能规范				
PN(MPa)	Shell Test(MPa)	Sealing Test(MPa)	Temperture (°C)	Medium
1.6	2.4	1.76	-29°C~425°C	Water, Steam, Oil, Gas, etc. 水、蒸气、油品等

NO. 序号	Name/名称	Material/材料					
1	Body/阀体	GS-C25+13Cr	1.4308	1.4408	CF3	CF3M	LCC+STL
2	Disc/阀瓣	1045+13Cr	1.4301	1.4401	F304L	F316L	1045+STL
3	Gasket/垫片	Fe360B	304	316	304L	316L	Fe360B
4	Nuts/六角螺母	A194 2H	A194 8	A194 8	A194 8	A194 8	1035
5	Split Pin/开口销	Fe360B	304	304	304	304	35CrMoA
6	Hinge/摇杆	GS-C25	1.4308	1.4408	CF3	CF3M	LCC
7	Pin/销轴	1.4021	F304	F316	F304L	F316L	F304
8	Yoke/支架	GS-C25	1.4308	1.4408	CF3	CF3M	LCC
9	Bolt/内六角螺钉	A193 B7	A194 8	A194 8	A194 8	A194 8	A193 B7
10	Gasket/复合垫片	304+GRAPHITE	304+GRAPHITE	304+GRAPHITE	304+GRAPHITE	304+GRAPHITE	304+GRAPHITE
11	Bolts/双头螺栓	A193 B7	A193 B8	A193 B8	A193 B8	A193 B8	A193 B7
12	Nuts/六角螺母	A194 2H	A194 8	A194 8	A194 8	A194 8	A194 2H
13	Bonnet/阀盖	GS-C25	1.4308	1.4408	CF3	CF3M	LCC
14	Eyebolt/吊环螺钉	A193 B7	A193 B7	A193 B7	A193 B7	A193 B7	A193 B7

DIN SWING CHECK VALVE PN16

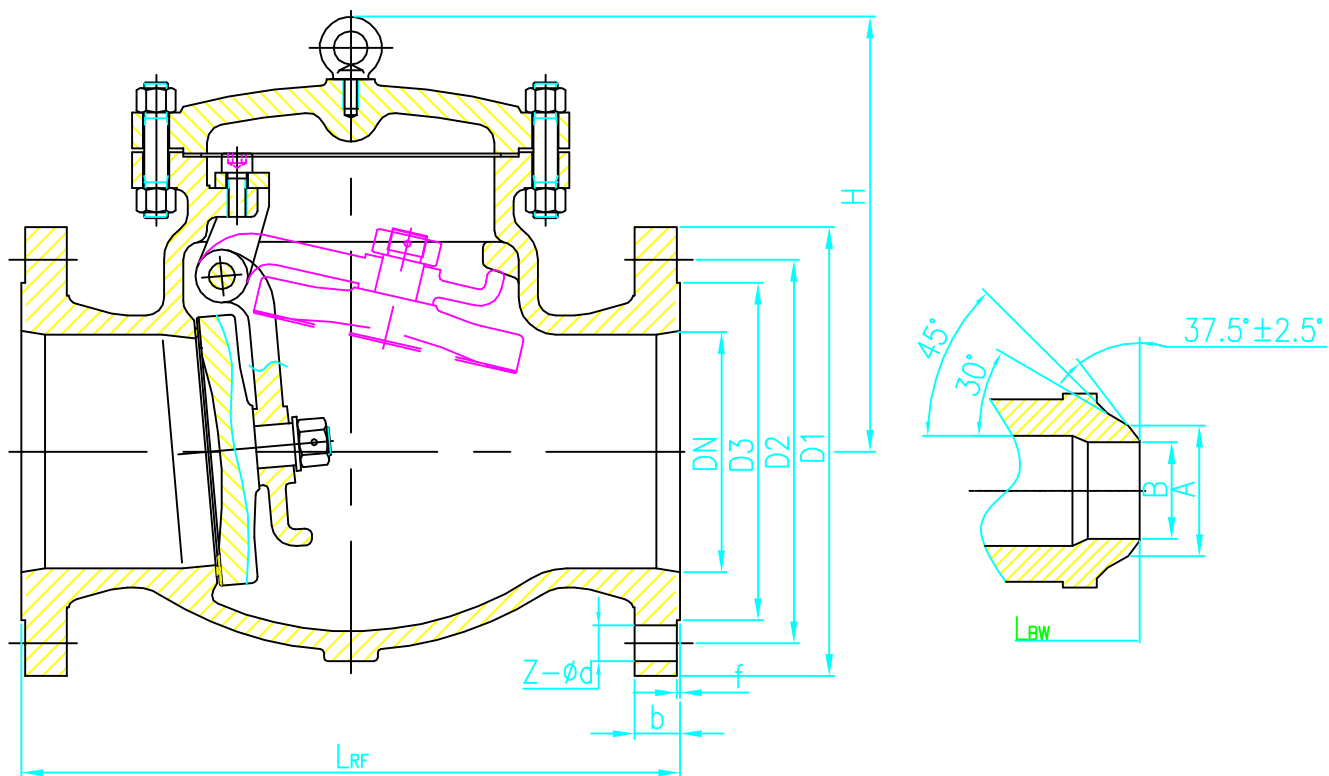

H44 (H, Y, W) -16 (C, P, R, I)

DN	L _{RF}	L _{BW}	D(φ)	D1(φ)	D2(φ)	f	b	Z-φd	A	B	H
50	230	230	165	125	99	2	20	4-φ18	60	52	140
65	290	290	185	145	118	2	20	4-φ18	75	63	148
80	310	310	200	160	132	2	20	8-φ18	91	78	175
100	350	350	220	180	156	2	22	8-φ18	117	102	190
125	400	400	250	210	184	2	22	8-φ18	144	128	210
150	480	480	285	240	211	2	24	8-φ22	172	154	235
200	600	600	340	295	266	2	24	12-φ22	223	203	308
250	730	730	405	355	319	2	26	12-φ26	278	255	350
300	850	850	460	410	370	2	28	12-φ26	329	305	390
350	980	980	520	470	429	2	30	16-φ26	362	337	430
400	1100	1100	580	525	480	2	32	16-φ30	413	387	468
450	1200	1200	640	585	548	2	40	20-φ30	464	438	495
500	1250	1250	715	650	609	2	44	20-φ33	516	489	530
600	1450	1450	840	770	720	2	54	20-φ36	619	591	615